

Manufactured in the USA - IBEW



Features

- 120-volt
- Compact design
- Accepts double contact bayonet T4 lamps
- Symmetrical reflector
- Hinged accessory holder
- Numerous mounting options
- Weight: 1.1 lbs

S100 150W T4



5 Holt Drive,
Stony Point, NY 10980
845-947-3034
info@tslight.com

The S100 is ideal for lighting applications that require a small compact unit that can produce a broad area of light. The S100 uses double contact bayonet base lamps up to 150-watts. The S100 is supplied with a hinged accessory, lamp access compartment. The use of tools is not required to change lamps, color filters or diffusers. A tempered clear glass lamp shield comes with each fixture.

Available in black, white and silver finishes. Custom colors are available by request and at an additional charge.

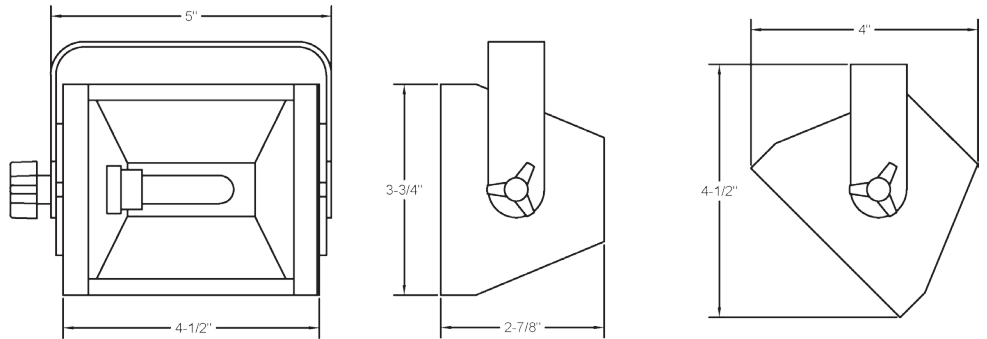

Lamp Types

ETC	100W; 2000Hrs; 2800 Lumens; 2950°K Color Temp
ETD	Frosted 100W; 1000Hrs; 1750 Lumens
ESP	150W; 1000Hrs; 2800 Lumens; 2950°K Color Temp
ETF	Frosted 150W; 2000Hrs; 2700 Lumens

Accessories

BD21	Barndoor
LV21	Louver
CF21	Color Frame
GF21	Glass Color Filter
DF21	Dichroic Color Filter
GF21-600	5°x50° Linear Lens
GF21-601	Beam Softener
GF21-673	50°x50° Spread Lens
GF21-702	UV Blocking Filter
CC18	Coiled Cord
SC-24	Safety Cable

Finish

B	Black
W	White
S	Silver
CC	Custom Color

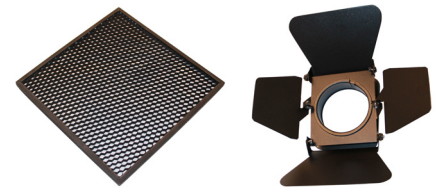

Extension Wands

SP 12	12" Stem
SP 18	18" Stem
SP 24	24" Stem
SP X	Custom Length

Model	Finish	Mounting	Accessories
WW38	B = Black W = White S = Silver CC = Custom Color	See Mounting Options	See Accessory Options

Example: S100-B-T1-BD21

S100I- _____ - _____ - _____

Photometric Data

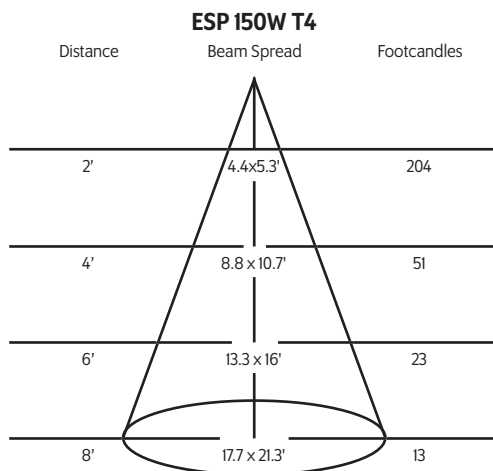
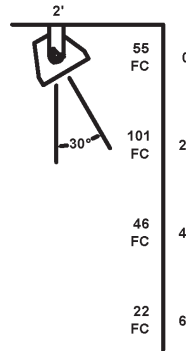
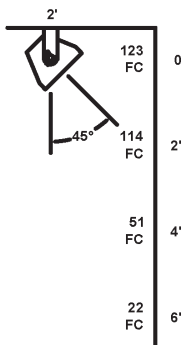
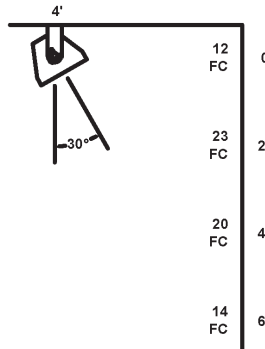
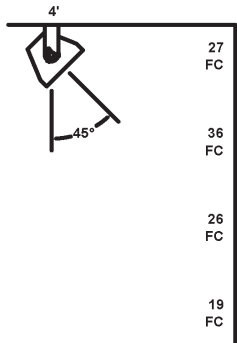
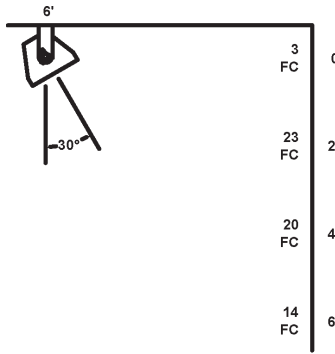
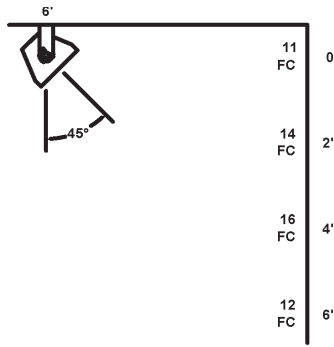

Mounting Options

ADI

Track adapter for commercial grade 1 & 2 circuit track. 120V. For use with Lightweight fixtures.

T1

Track adapter for commercial grade 1 & 2 circuit track. 120V. For use with larger, heavier fixtures.

TA2 / HTA2 (277)

Track adapter for G-Series specification grade 2-circuit track. 120V or 277V.

TA3

Track adapter for G-Series specification grade 3-circuit track. 120V.

TA1 / TE2 (2 circuit)

Track adapter for E-Series specification grade track. 1 or 2 circuit. 120V.

STA

2 circuit track adapter for Data Bus. Specification grade track. 120V.

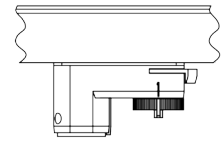

CM4

Canopy mount.



US1

6 5/8" x 1 1/2" Unistrut adapter.



TB4

6 1/4" Portable wall mount/table base floor, wall or table use.

TB8

8" x 8" Portable table base for floor or table use.



MC

Light duty pipe clamp for small fixtures. For pipes up to 1 5/16" O.D.

MN

Medium duty pipe clamp for small to large fixtures. For pipes up to 2" O.D.

PC9M

Heavy duty pipe clamp for large, heavy fixtures. For pipes up to 2" O.D.

