

# AR11

## SORAA LED



5 Holt Drive,  
Stony Point, NY 10980  
845-947-3034  
info@tslight.com

Features an 18.5 Watt Soraa 9° AR11 LED lamp that is ideal for hospitality, restaurant, retail and artwork lighting. It is available in 95 CR and has a light output that mirrors a 75 Watt 12V AR11 lamp.

By utilizing Soraa's Snap System, there are unlimited possibilities for customizing this fixture. Options include the ability to field change the beam angle (Beam Spreader Snap), alter color temperature (CTO Snap), or to add a louver. Color Snaps can be used to produce brilliant hues of any color that Rosco or Lee offer.

Manufactured in the USA - IBEW



### Features

- 120, 220 and 277-volt available
- Integral 12-volt dimmable driver
- Available in 2700K and 3000K.
- Rated life of 35,000 hours
- Numerous mounting options and accessories
- Weight: 2 lbs

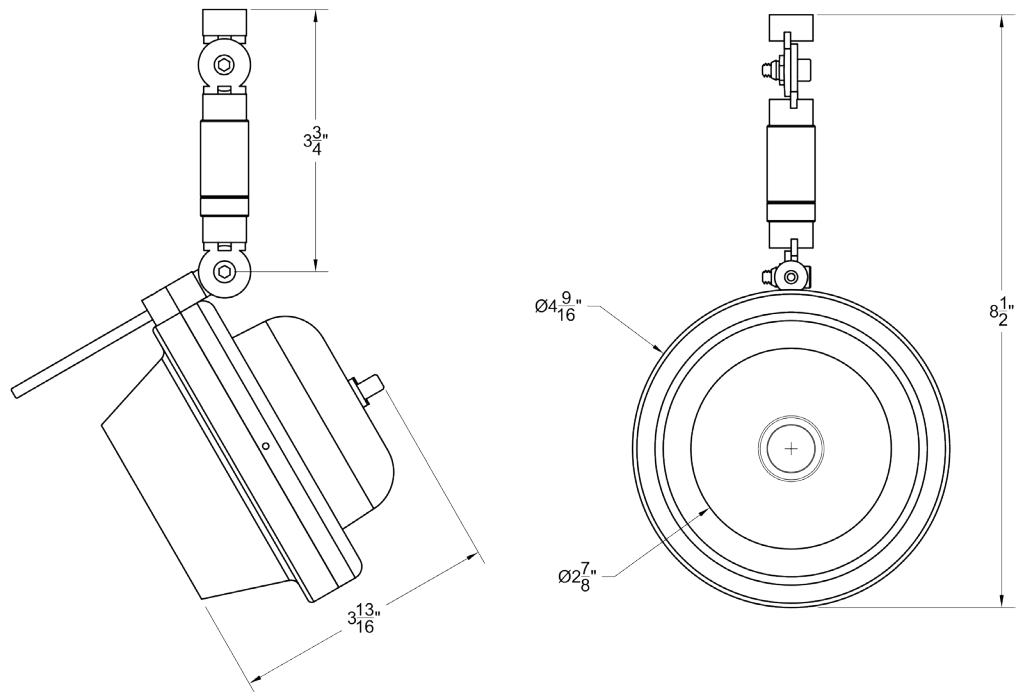

Lamp Type	Watts	CRI	Lumens*
Vivid	18.5	95 (R9=95)	1000

\*Lumens vary depending on color temperature - results for 3000K lamp used above.

### Ordering Matrix

Model	CRI	Color Temperature	Color	Mounting Options	Accessories
R11	95	27 = 2700K 30 = 3000K	B=Black W=White S=Silver CC=Custom Color	See Mounting Options for Ordering Codes	See Accessory Options for Ordering Codes

\*All fixtures sold with 9° beam angle lamps – use Beam Spreaders to achieve desired angle.

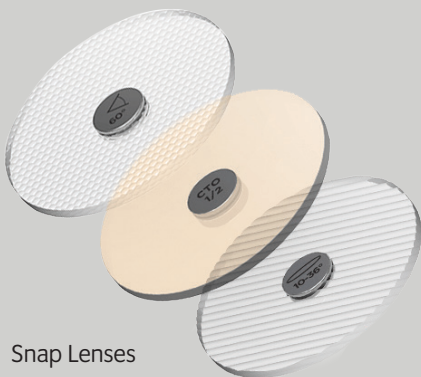

Snap Lenses

**Example:** R11-9527-B-CM1-

R11- \_\_\_\_\_ - \_\_\_\_\_ - \_\_\_\_\_

\*Specification sheets are subject to change without notice.

## Photometric Data

### 9° Degree Beam

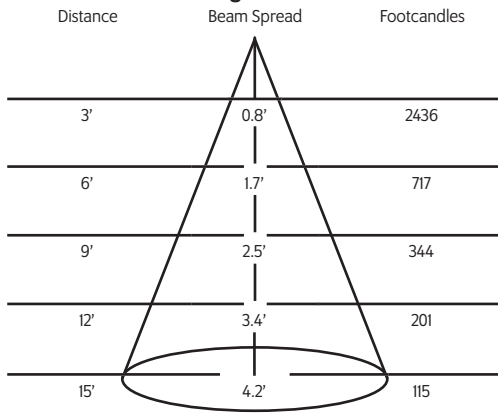

### 25° Degree Beam

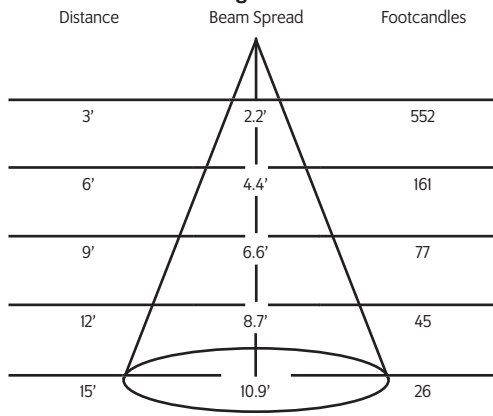

### 36° Degree Beam

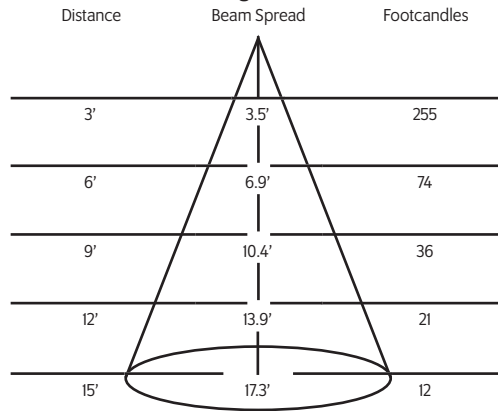

### 60° Degree Beam

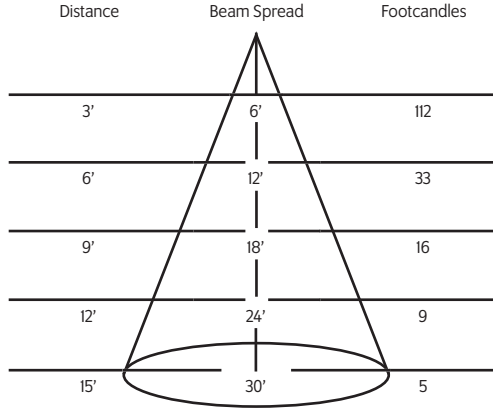

\* Beam spread calculated based on field diameter.

## Mounting Options

**N13** Track adapter for commercial grade 1 & 2 circuit track. 120V.

**N2** Track adapter for G-Series specification grade 2-circuit track. 120V.

**N7** Track adapter for G-Series specification grade 2-circuit track. 277V.

**N3** Track adapter for G-Series specification grade 3-circuit track. 120V.

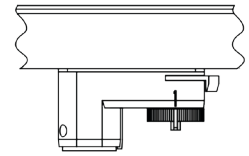

**CM1** Canopy mount.

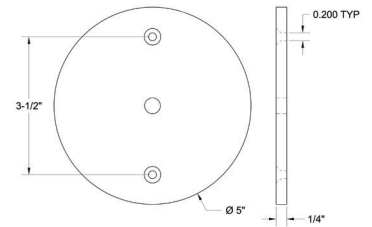

## Snap Accessories

- 01145** 25° Beam Spreader Snap
- 01147** 36° Beam Spreader Snap
- 01149** 60° Beam Spreader Snap
- 01595** 10°-36° Linear Snap
- 03261** 10°-60° Linear Snap
- 01597** 36°X36° Flat Top Snap
- 01151** 40° Cutoff Louver
- 03257** 20° Maximum Deflection Snap
- 01153** ¼ Color Temperature Shift Snap
- 01155** ½ Color Temperature Shift Snap
- 01157** ¾ Color Temperature Shift Snap
- 03283** Enhance Snap
- 02185-C** Color Snap (Specify Color)

## IES Files

Visit [tslight.com](http://tslight.com) to find comprehensive IES data.