



AR111

SORAA LED



5 Holt Drive,
Stony Point, NY 10980
845-947-3034
info@tslight.com

Features an 18.5 Watt Soraa AR111 lamp that produces a tight, narrow beam at 9° with a crisp edge. It is ideal for hospitality, restaurant, retail and artwork lighting. It is available in 95 CRI, and has a light output that mirrors a 75 Watt 12V AR111 lamp.

By utilizing Soraa's Snap System, there are unlimited possibilities for customizing this fixture. Options include the ability to field change the beam angle (Beam Spreader Snap), alter color temperature (CTO Snap), or to add a louver. Color Snaps can be used to produce brilliant hues of any color that Rosco or Lee offer.

The Enhance Lens Snap can increase the vividness of warm colors (including red, orange and pink and greens). Aim Snaps can bend the beam to a maximum deflection angle of 20°. Linear Snap Lenses can alter the beam to act as a wall wash.

Additional fixture features include an adjustable head and hinged front for easy re-lamping. Internal accessory holder accepts louvers, barndoors, hoods and a variety of filters. Available in standard black, white and silver finishes. Custom colors are available by request and at an additional charge.

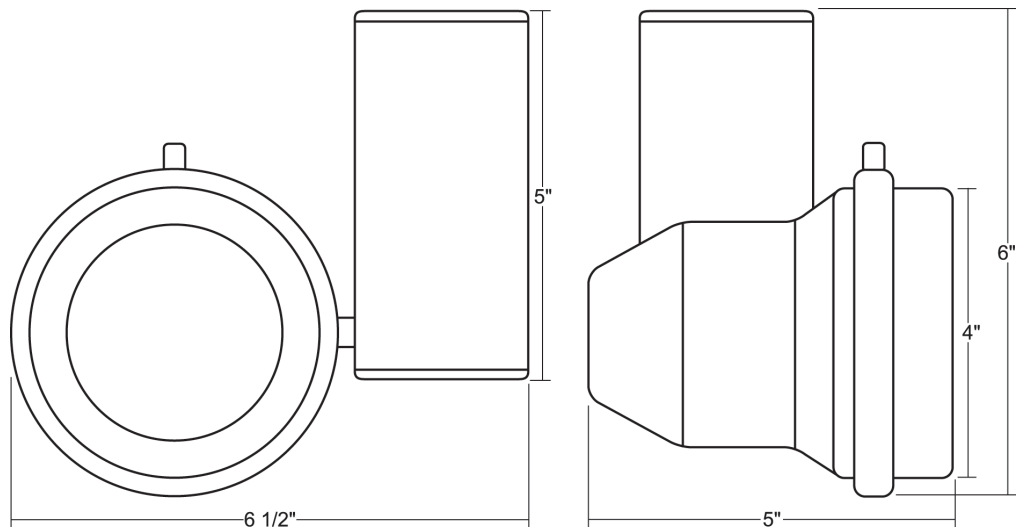

PRODUCT LISTED
BY A NATIONALLY
RECOGNIZED
TESTING
LABORATORY



Features

- 120, 220 and 277-volt available
- Integral 12-volt dimmable driver
- Use with electronic low voltage (ELV) Dimmer only (AKA Trailing Edge and Reverse Phase)
- Available in 2700K and 3000K
- Rated life of 35,000 hours
- Numerous mounting options and accessories
- Dimmable
- **Weight:** 2 lbs

Lamp Type	Watts	CRI	Lumens*
Vivid	18.5	95 (R9=95)	1000

* Lumens vary depending on color temperature - results for 3000K lamp used above.

Ordering Matrix

Model	CRI	Color Temperature	Color	Mounting Options	Accessories
CSR111	95	27 = 2700K 30 = 3000K	B=Black W=White S=Silver CC=Custom Color	See Mounting Options for Ordering Codes	See Accessory Options for Ordering Codes

* All fixtures sold with 9° beam angle lamps – use Beam Spreaders to achieve desired angle.

Example: CSR111-9527-B-ADI-LV6

CSR111-_____-_____-_____-_____-_____

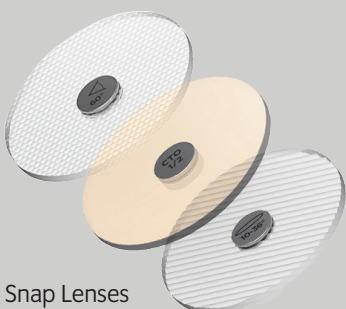

Snap Lenses

* Specification sheets are subject to change without notice.

Photometric Data

9° Degree Beam

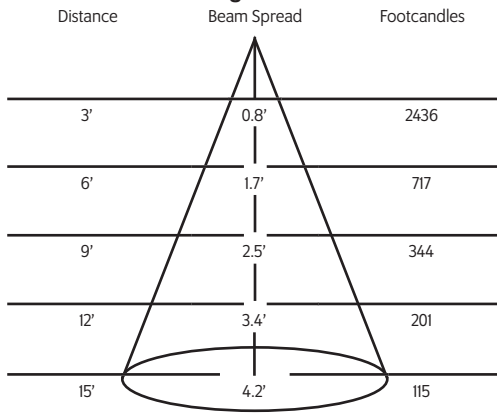

25° Degree Beam

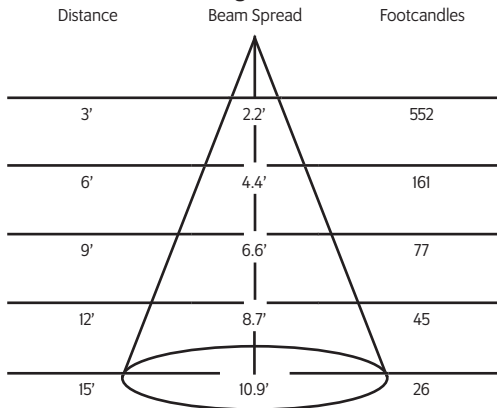

36° Degree Beam

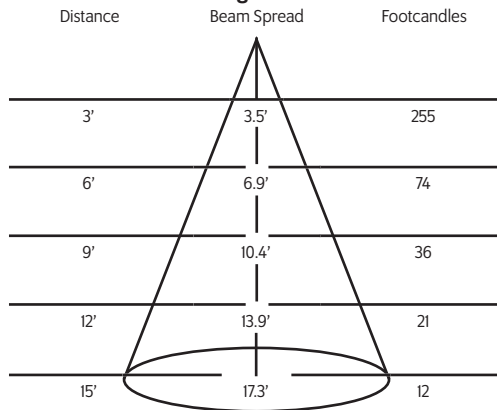

60° Degree Beam

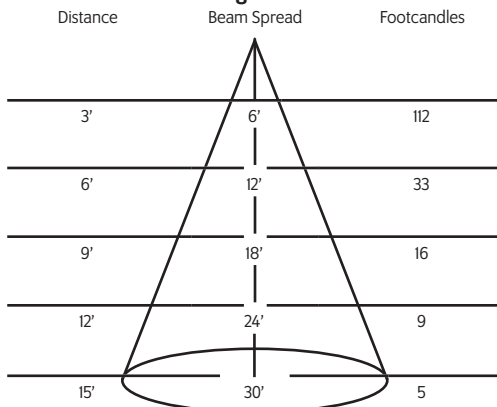

*Beam spread calculated based on field diameter.

Mounting Options

AD1 Track adapter for commercial grade 1-circuit track. Good for use with small, lightweight fixtures.

DT2 Track adapter for SpecTrack 2-Circuit data track. 120V.

HDT2 Track adapter for SpecTrack 2-Circuit data track. 277V.

TA2 Track adapter for G-Series specification grade 2-circuit track. 120V.

HTA2 Track adapter for G-Series specification grade 2-circuit track. 120V.

TA3 Track adapter for G-Series specification grade 3-circuit track. 120V.

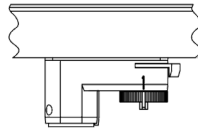

CM4 Canopy mount.

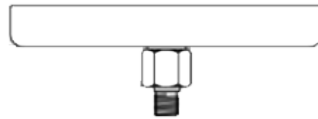

US1 6 5/8" x 1 1/2" Unistrut adapter.



TB4 6 1/4" Portable wall mount/table base floor, wall or table use.



MC Light duty pipe clamp for small fixtures. For pipes up to 15/16" O.D.



MN Medium duty pipe clamp for small to large fixtures. For pipes up to 2" O.D.

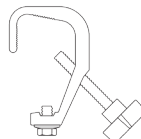

Snap Accessories

01145	25° Beam Spreader Snap
01147	36° Beam Spreader Snap
01149	60° Beam Spreader Snap
01595	10°-36° Linear Snap
03261	10°-60° Linear Snap
01597	36°X36° Flat Top Snap
01151	40° Cutoff Louver
03257	20° Maximum Deflection Snap
01153	¼ Color Temperature Shift Snap
01155	½ Color Temperature Shift Snap
01157	¾ Color Temperature Shift Snap
03283	Enhance Snap
02185-C	Color Snap (Specify Color)

Fixture Accessories

LV6	Louver
XL6	Cross Baffle Louver
BD10	Barndoor
HD6	Hood
XH6	Cross Baffle Hood
CC18	Coiled Cord
SC-24	Safety Cable



Extension Wands

SP 12	12" Stem
SP 18	18" Stem
SP 24	24" Stem
SP X	Custom Length

Finish

B	Black
W	White
S	Silver
CC	Custom Color

Connector/Plug Types (Optional)

ED	Edison Connector
TL	Twist Lock Connector
SP	Stage Pin Connector

IES Files

Visit tslight.com to find comprehensive IES data.