

AR11

SORAA LED



5 Holt Drive,
Stony Point, NY 10980
845-947-3034
info@tslight.com

Features an 18.5 Watt Soraa 9° AR11 LED lamp that is ideal for hospitality, restaurant, retail and artwork lighting. It is available in 95 CR and has a light output that mirrors a 75 Watt 12V AR11 lamp.

By utilizing Soraa's Snap System, there are unlimited possibilities for customizing this fixture. Options include the ability to field change the beam angle (Beam Spreader Snap), alter color temperature (CTO Snap), or to add a louver. Color Snaps can be used to produce brilliant hues of any color that Rosco or Lee offer.

Manufactured in the USA - IBEW

PRODUCT LISTED
BY A NATIONALLY
RECOGNIZED
TESTING
LABORATORY



Features

- 120, 220 and 277-volt available
- Integral 12-volt dimmable driver
- Use with electronic low voltage (ELV) Dimmer only (AKA Trailing Edge and Reverse Phase)
- Available in 2700K and 3000K.
- Rated life of 35,000 hours
- Numerous mounting options and accessories
- Weight: 2 lbs

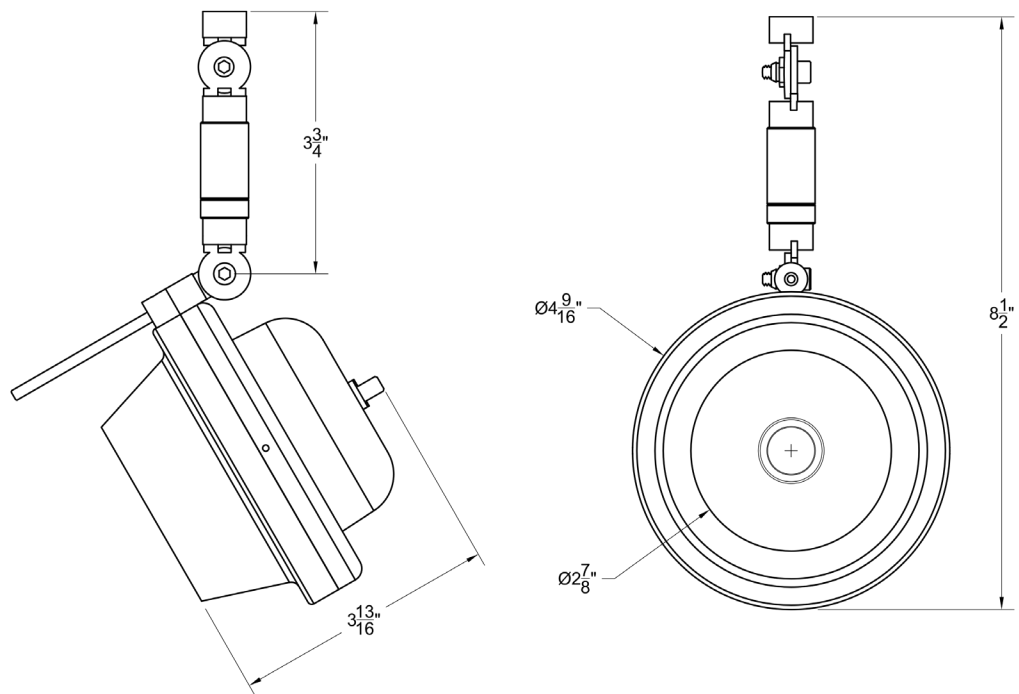

| Lamp Type | Watts | CRI | Lumens* |
|-----------|-------|------------|---------|
| Vivid | 18.5 | 95 (R9=95) | 1000 |

*Lumens vary depending on color temperature - results for 3000K lamp used above.

Ordering Matrix

| Model | CRI | Color Temperature | Color | Mounting Options | Accessories |
|-------|-----|--------------------------|---|---|--|
| R11 | 95 | 27 = 2700K 30 = 3000K | B=Black W=White S=Silver CC=Custom Color | See Mounting Options for Ordering Codes | See Accessory Options for Ordering Codes |

*All fixtures sold with 9° beam angle lamps – use Beam Spreaders to achieve desired angle.

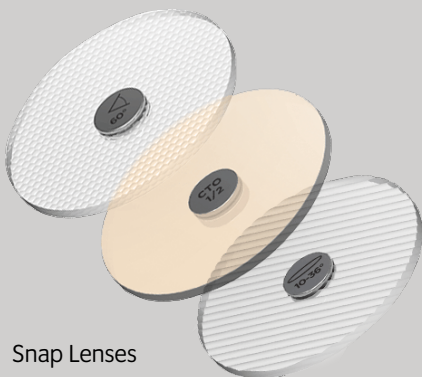

Snap Lenses

Example: R11-9527-B-CM1

R11- _____ - _____ - _____

*Specification sheets are subject to change without notice.

Photometric Data

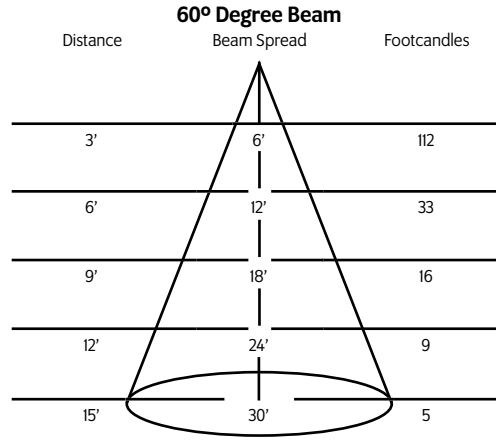
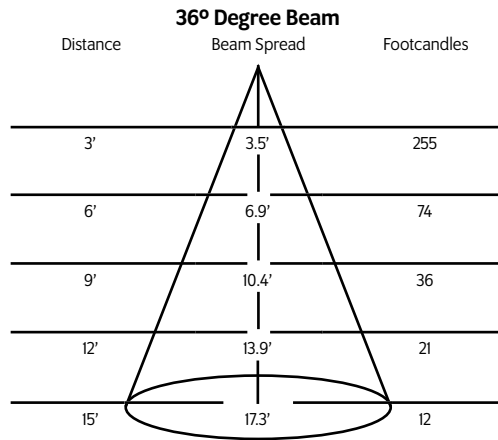
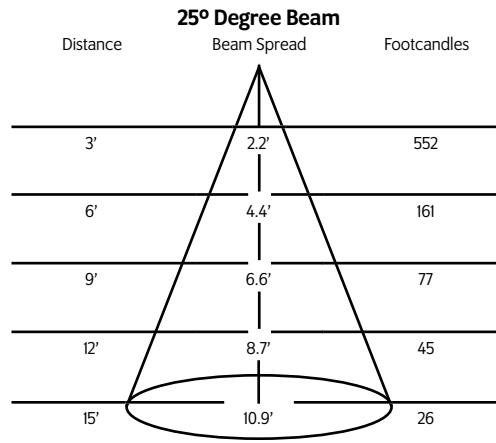
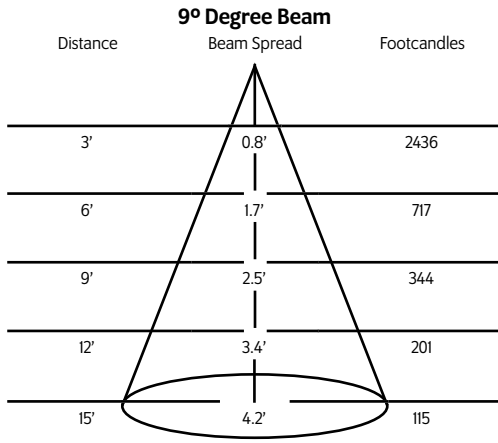

*Beam spread calculated based on field diameter.

Mounting Options

N13 Track adapter for commercial grade 1 & 2 circuit track. 120V.

N2 Track adapter for G-Series specification grade 2-circuit track. 120V.

N7 Track adapter for G-Series specification grade 2-circuit track. 277V.

N3 Track adapter for G-Series specification grade 3-circuit track. 120V.

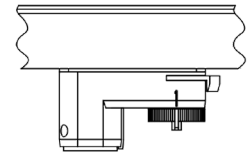

CM1 Canopy mount.

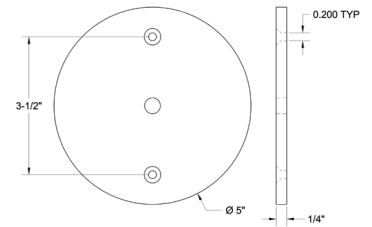

Snap Accessories

- 01145** 25° Beam Spreader Snap
- 01147** 36° Beam Spreader Snap
- 01149** 60° Beam Spreader Snap
- 01595** 10°-36° Linear Snap
- 03261** 10°-60° Linear Snap
- 01597** 36°X36° Flat Top Snap
- 01151** 40° Cutoff Louver
- 03257** 20° Maximum Deflection Snap
- 01153** ¼ Color Temperature Shift Snap
- 01155** ½ Color Temperature Shift Snap
- 01157** ¾ Color Temperature Shift Snap
- 03283** Enhance Snap
- 02185-C** Color Snap (Specify Color)

IES Files

Visit tslight.com to find comprehensive IES data.