



Manufactured in the USA - IBEW

Features

- Designed for 2-pin MR16 lamps up to 75-watts
- 120, 220 and 277-volt available
- Integral 12-volt dimmable electronic transformer
- Hinged front for easy re-lamping
- Multiple accessory holder
- Clear glass safety shield
- Numerous mounting options
- Weight: 2 lbs

2016C

20-75W MR16



5 Holt Drive,
Stony Point, NY 10980
845-947-3034
info@tslight.com

The 2016C is a low voltage fixture ideal for highlighting artwork, exhibits, and retail displays. The unit accepts energy efficient MR16 lamps from 20 to 75-watts. These lamps come in a variety of beam spreads, which are interchangeable as needed. They offer excellent color rendering and produce a whiter, brighter light than standard incandescent lamps with longer lamp life and less heat output.

The 2016C features an adjustable self-locking head and an electronic transformer. It has a hinged front that is easily opened for re-lamping and an internal accessory holder that can accommodate louvers, barndoors, hoods and a variety of filters. Comes in standard black, white and silver finishes. Custom colors are available by request and at an additional charge.

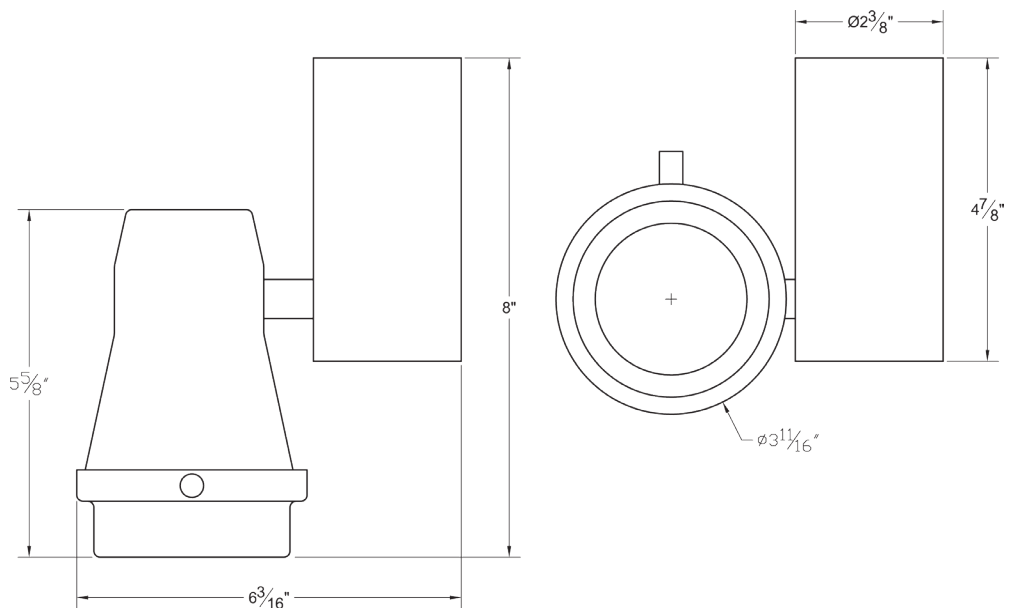

Lamp Types

Q42MR16/C/VNSP9

42W/12V; EZY; 3500Hrs; 9° Beam; 12300 CBCP; 3000°K Color Temp

Q50MR16/C/NSPI5

50W/12V; EXT; 6000Hrs; 15° Beam; 9100 CBCP; 3050°K Color Temp

Q50MR16/C/NFL25

50W/12V; EXZ; 6000Hrs; 25° Beam; 3200 CBCP; 3050°K Color Temp

Q50MR16C/NFL30

50W/12V; EXZ; 6000Hrs; 30° Beam; 2500 CBCP; 3050°K Color Temp

Q50MR16/C/FL40

50W/12V; EXN; 6000Hrs; 25° Beam; 1700 CBCP; 3050°K Color Temp

Q50MR16/C/WFL55

50W/12V; FNV; 6000Hrs; 25° Beam; 900 CBCP; 3050°K Color Temp

Q71MR16/C/NSPI5

71W/12V; EYF; 4000Hrs; 15° Beam; 11500 CBCP; 3050°K Color Temp

Q71MR16/C/NFL25

71W/12V; EYJ; 4000Hrs; 25° Beam; 5500 CBCP; 3050°K Color Temp

Q71MR16/C/FL40

71W/12V; EYC; 4000Hrs; 40° Beam; 2200 CBCP; 3050°K Color Temp

Ordering Matrix

Model	Finish	Mounting	Accessories
2016C	B = Black W = White S = Silver CC = Custom Color	See Mounting Options	See Accessory Options

Example: 2016C-B-T1-LV1

2016C-_____ - _____ - _____

Photometric Data

Q71MR16/C/NSPI5 15°

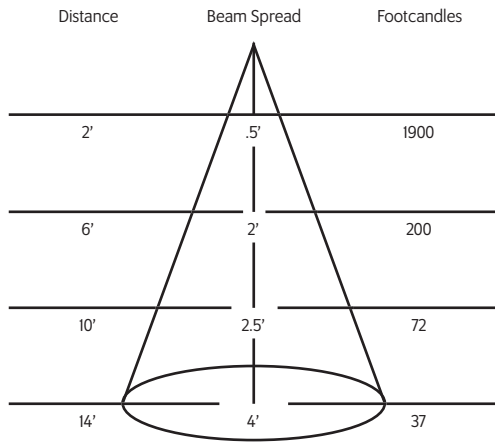

Q71MR16/C/FL40 40°

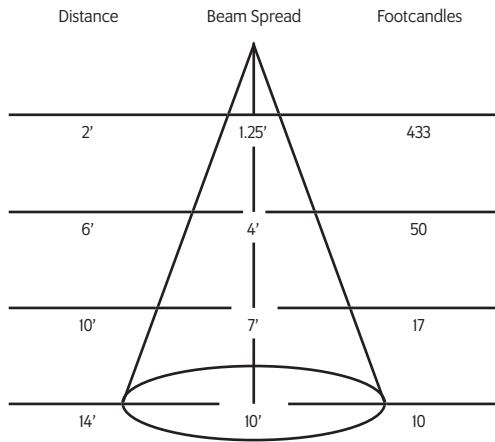

Mounting Options

AD1

Track Adapter for commercial grade 1-circuit track. 120V. For use with lightweight fixtures.

T1

Track adapter for commercial grade 1 & 2 circuit track. 120V. For use with larger, heavier fixtures.

TA2 / HTA2 (277)

Track adapter for G-Series specification grade 2-circuit track. 120V or 277V.

TA3

Track adapter for G-Series specification grade 3-circuit track. 120V.

TA1 / TE2 (2 circuit)

Track adapter for E-Series specification grade track. 1 or 2 circuit. 120V.

ST2

2 circuit track adapter for Data Bus. Specification grade track. 120V.

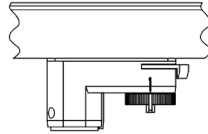

CM4

Canopy mount.

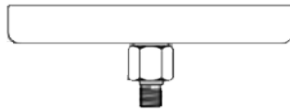

US1

6 5/8" x 1 1/2" Unistrut adapter.



TB4

6 1/4" Portable wall mount/table base floor, wall or table use.

TB8

8" x 8" Portable table base for floor or table use.



MC

Light duty pipe clamp for small fixtures. For pipes up to 15/16" O.D.

MN

Medium duty pipe clamp for small to large fixtures. For pipes up to 2" O.D.

PC9M

Heavy duty pipe clamp for large, heavy fixtures. For pipes up to 2" O.D.

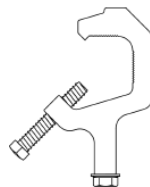

Accessories

LV3

Louver

XL3

Cross Baffle Louver

BD3

Barndoor

HD3

Hood

SH3

Sparkle Hood

GF3

Glass Color Filter

DF3

Dichroic Color Filter

GF3-600

5°x50° Linear Lens

GF3-601

Beam Softener

GF3-673

50°x50° Spread Lens

GF3-702

UV Blocking Filter

CC18

Coiled Cord

SC-24

Safety Cable

DM

Integral Dimmer

WW3

Wall Wash Kicker w/
Spread Lens



Extension Wands

SP 12

12" Stem

SP 18

18" Stem

SP 24

24" Stem

SP X

Custom Length

Finish

B

Black

W

White

S

Silver

CC

Custom Color