

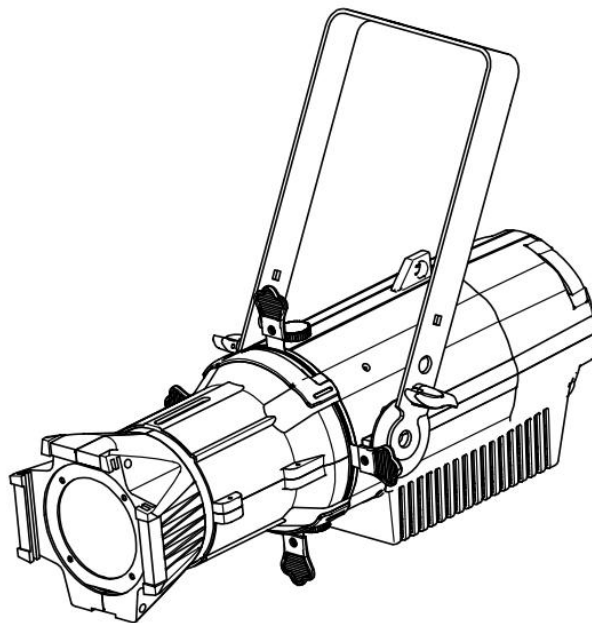

V300

User Manual



CE RoHS  IP20

1 SAFETY INSTRUCTIONS



CAUTION

Be careful with your operations. With a dangerous voltage you can suffer a dangerous electric shock when touching wires!

This device has left the factory in perfect condition. In order to maintain this condition and to ensure a safe operation, it is absolutely necessary for the user to follow the safety instructions and warning notes written in this user manual.



IMPORTANT

Damages caused by the disregard of this user manual are not subject to warranty. The dealer will not accept liability for any resulting defects or problems.

If the device has been exposed to temperature changes due to environmental changes, do not switch it on immediately. The arising condensation could damage the device.

Leave the device switched off until it has reached room temperature.

This device falls under protection-class I. Therefore it is essential that the device be earthed.

The electric connection must be carried out by a qualified person. The device shall only be used with rated voltage and frequency.

Make sure that the available voltage is not higher than stated at the end of this manual.

Make sure the power cord is never crimped or damaged by sharp edges. If this would be the case, replacement of the cable must be done by an authorized dealer.

Always disconnect from the mains, when the device is not in use or before cleaning it. Only handle the power cord by the plug. Never pull out the plug by tugging the power cord.

During initial start-up some smoke or smell may arise. This is a normal process and does not necessarily mean that the device is defective, it should decrease gradually.

Please don't project the beam onto combustible substances.

Fixtures cannot be installed on combustible substances, keep more than 50cm distance with wall for smooth air flow, so there should be no shelter for fans and ventilation for heat radiation.

If the external flexible cable or cord of this luminaire is damaged, it shall be exclusively replaced by the manufacturer or his service agent or a similar qualified person in order to avoid a hazard.

2 Unpacking

Thank you for choosing our PROFILE 300RGBAL. For your own safety, please read this manual before installing the device. This manual covers the important information on installation and applications. Please install and operate the fixture with following instructions. Meanwhile, please keep this manual well for future needs.

The PROFILE 300RGBAL is made of a new type of high temperature strength of die cast aluminum casing with nice outlook. The fixture is designed and manufactured strictly following CE&RoHS standards, complying with international standard DMX512 protocol. It's available independently controlled and linkable with each other for operation. And it is applicable for large-scale live performances, theater, studio, nightclubs and discos.

The PROFILE 300RGBAL adopts 1PCS 300W COB LED (available for RGBAL) which features high brightness and stability. Please carefully unpack it when you receive the fixture and check whether it is damaged during the transportation. And please check whether the following items are included inside the box:

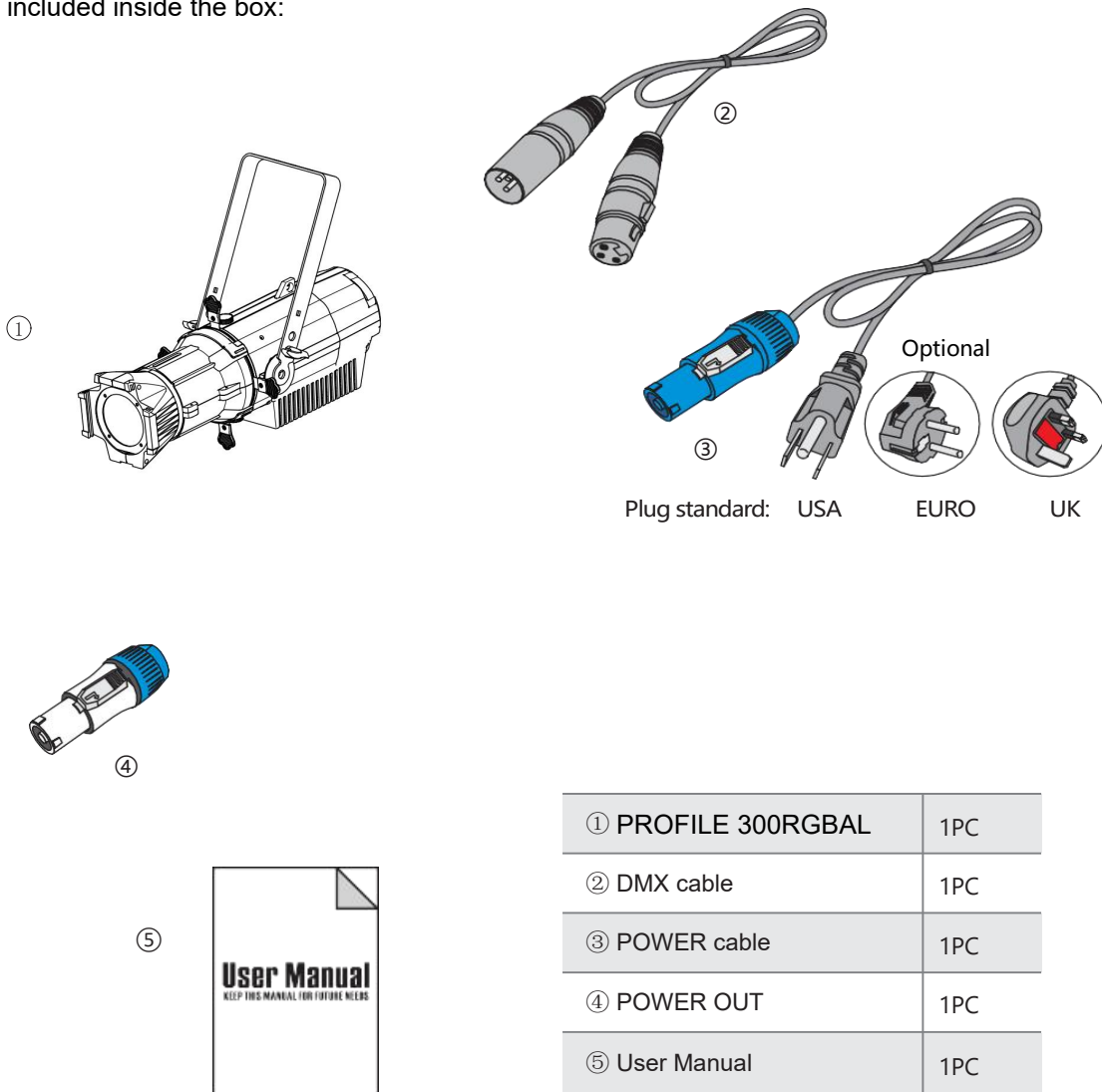

① PROFILE 300RGBAL	1PC
② DMX cable	1PC
③ POWER cable	1PC
④ POWER OUT	1PC
⑤ User Manual	1PC

3 FEATURES & SPECIFICATIONS

Feature:
*1X300W COB LED (RGBAL 5IN1)
*50,000 hours life time and low power consumption
*Color Rendering Index(CRI): Ra≥90
*High quality optical system and field uniformity
*High contrast aspheric lens
*Fixed Lens: 19°/26°/36°/50°(optional)
*Fully Tuneable from 2,700 to 12,000K, similar to sunrise to sunset
*With RGBAL full color, intelligent color mix system. Adjust high quality mix color
*Die casting aluminum housing design
*4 Metal spot cutting slots
*4 kinds of dimming curve
*Dimming Frequency: 500HZ - 25000HZ optional
*Strobe :1-25times/sec
*5/10 DMX channels
*Control Protocol: RDM / DMX , Master/Slave ,Auto run and sound mode
*LCD with touch screen
*Low noise fan with copper liquid cooling system
*Working Temperature: -10°C~40°C
*IP20 protection rating
Specifications:
*Input Voltage:AC100-240V 50/60Hz
*Max. Power :300W
*Dimensions: 611(D)*173(W)*480(H)mm
*Packing Size: 720(D)*330(W)*315(H)mm
*Net Weight: 10.5kg
*Gross Weight: 12.5kg

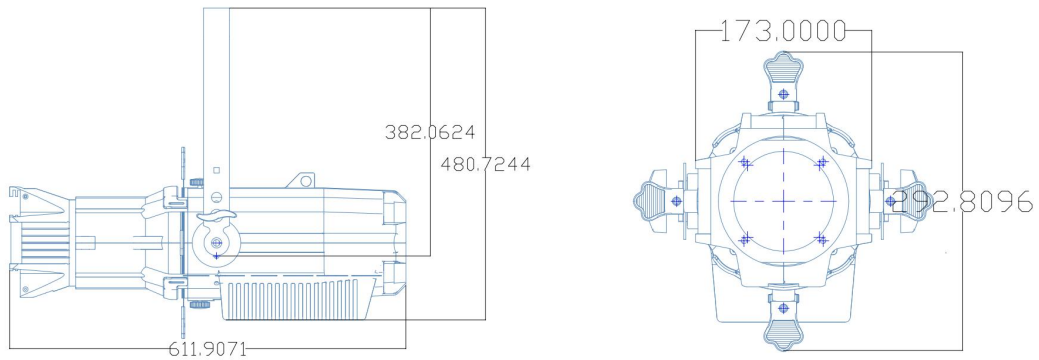

4 DMX-512 CONTROL CONNECTIONS

Connect the provided XLR cable to the female 3-pin XLR output of your controller and the other side to the male 3-pin XLR input of the moving head. You can chain multiple Moving head together through serial linking. The cable needed should be two core, screened cable with XLR input and output connectors. Please refer to the diagram below.
DMX-512 connection with DMX terminator

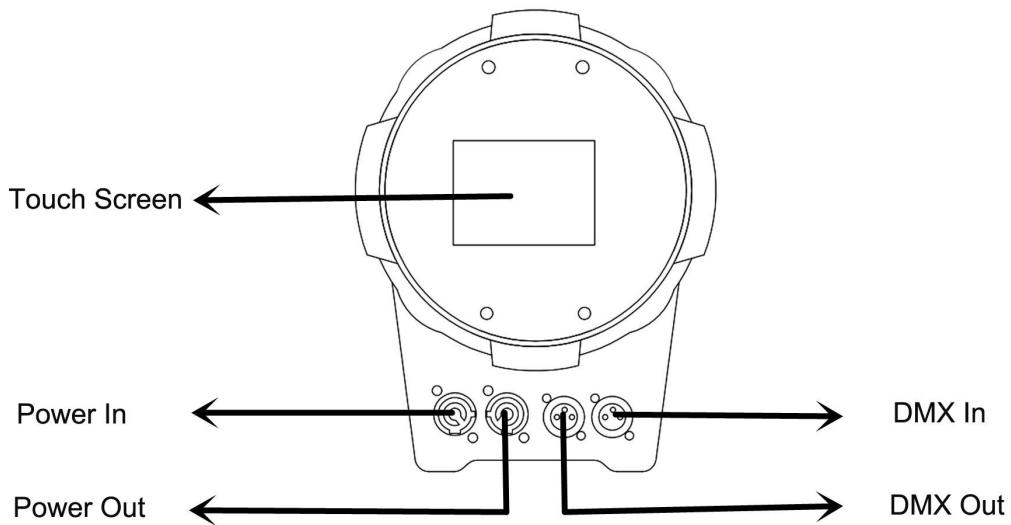

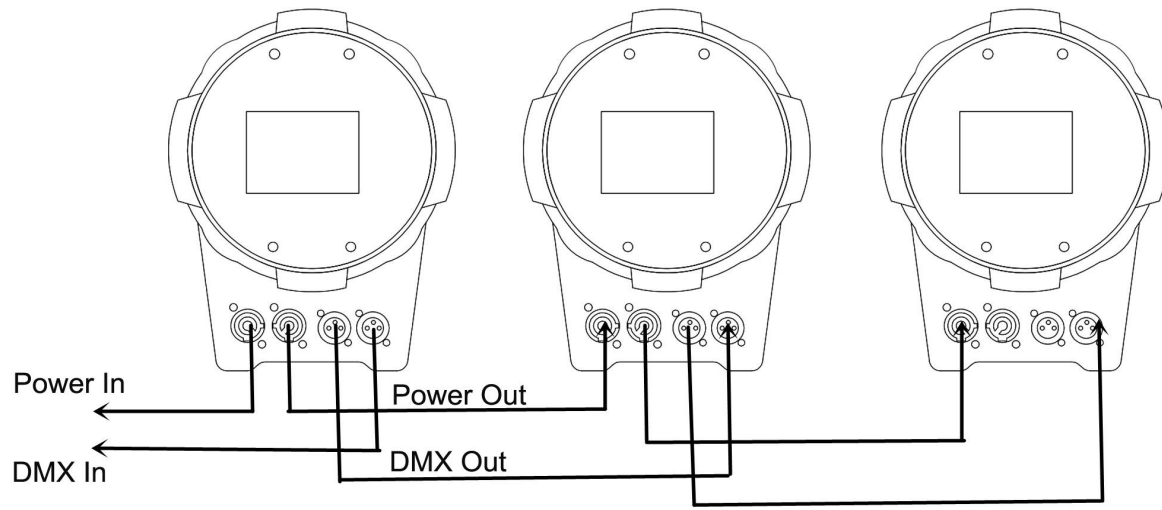

- 1:Ground
- 2:Data(-)
- 3:Data(+)

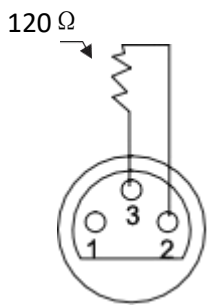
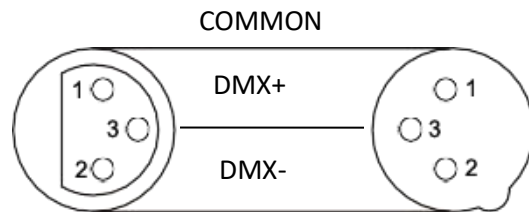

For installations where the DMX cable has to run a long distance or is in an electrically noisy environment, such as in a discotheque, it is recommended to use a DMX terminator. This helps in preventing corruption of the digital control signal by electrical noise. The DMX terminator is simply an XLR plug with a 120 Ω resistor connected between pins 2 and 3, which is then plugged into the output XLR socket of the last fixture in the chain. Please see illustrations below.

5 Main Menu

5.1 Main Menu

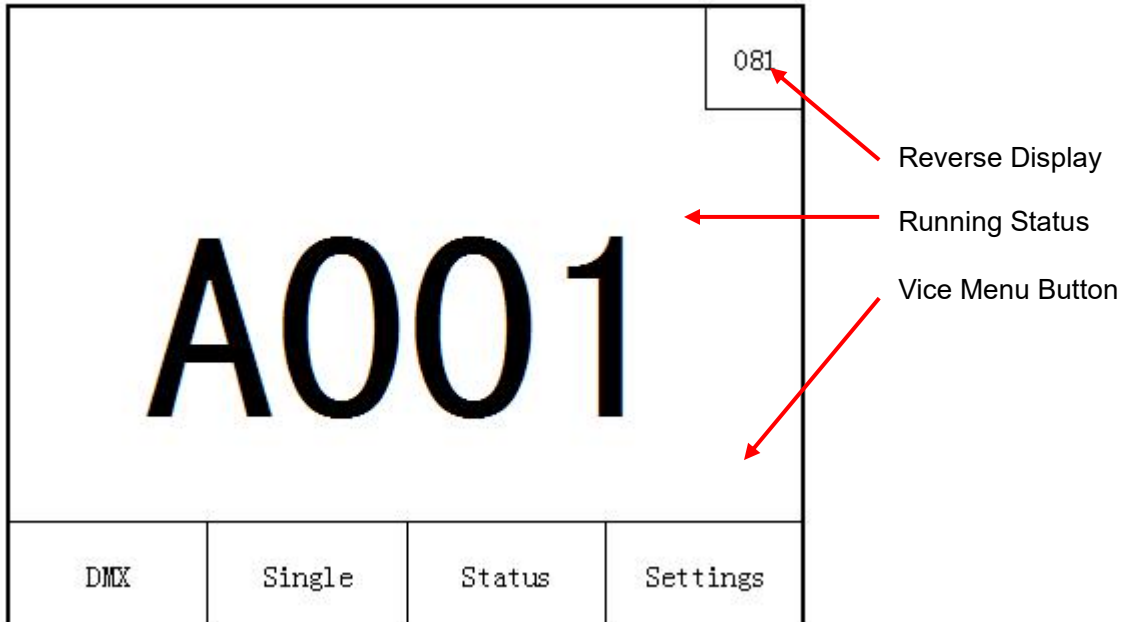

5.2 Operation Status

Mode	Display	Description
DMX Mode Master-slave	Axxx	"A"stand for standard channel mode, "xxx"stand for ID address, Auto identify controller signals or host signals
	Dxxx	"D"stand for basic channel mode, "xxx"stand for ID address, Auto identify controller signals or master signals
Manual	M-MC	"M"stand for Master mode, "MC"stand for "Mixed Color"
Auto run	M-Ax	"M"stand for Master mode, "A"stand for "Auto", "x" is Auto program number(1~8)
Sound activated	M-Sx	"M"stand for Master mode, "S"stand for "Sound", "x" is Sound activated (1 or 2)
Color Temperature	M-WP	"M"stand for Master mode, "WP"stand for"White Point"
Select Color	M-QC	"M"stand for Master mode, "QC"stand for"Quick Color"

6 Vice Menu

DMX Settings

Menu	Operation	Option	Description
DMX Start Address	Press key of "OK" enter to edit mode, press "UP" and "down" to edit the DMX address	1~512	
DMX Profile	Press key of "OK" change the DMX channel mode	10CH	Standard Channel Mode
		5CH	Basic Channel Mode

Master Mode Choice

Menu	Operation	Vice Menu description
Mixed Color	Press Key of "OK" to choose mode	Choose the color and strobe setting
Auto Mode	Same as above	Choose the Auto and Speed setting
Sound Mode	Same as above	Choose the Sound and Mode setting
White Point	Same as above	Choose the color temperature
Quick Color	Same as above	Choose the built-in color

Status

Menu	Description
Software	Name of software
Version	Version
Temperature	Show the temperature of lighting fixture
DMX Status	With "OK" (Slave mode, with signal), "NONE" (Slave mode, no signal), "Master" (Master)

Settings

Menu	Operation	Option	Description
Touch Screen Calibration	Touch screen adjust		
Dimmer Frequency	Change the dimmer frequency	500Hz	
		
		25000Hz	
Dimmer Curve	Change dimmer curve	Standard	
		Incandescent	
		Linear	
		Quick	
Over Temperature	Temperature setting	80~100	Each 5 for increase or decrease
Backlight	Adjust the display brightness	10%~100%	Each 5% for increase or decrease
Backlight Timeout	Screen protect setting	No screen protect or black screen from 0~ 60 second	Each 5 for increase or decrease
Load Factory Settings	Reset		

7 DMX CHANNELS

Standard channel mode(10CH)

Channel	Data	Function	Remark
1	0~255	Dimmer	
2	0~255	Color 1	
3	0~255	Color 2	
4	0~255	Color 3	
5	0~255	Color 4	
6	0~255	Color 5	
7	0~10	No function	
	10~20	Color Temperature 2700K	
	20~30	Color Temperature 3000K	
	30~40	Color Temperature 3200K	
	40~50	Color Temperature 3600K	
	50~60	Color Temperature 4000K	
	60~70	Color Temperature 4200K	
	70~80	Color Temperature 4500K	
	80~90	Color Temperature 5600K	
	90~100	Color Temperature 6000K	
	100~110	Color Temperature 6500K	
	110~120	Color Temperature 7200K	
	120~130	Color Temperature 8000K	
	130~140	Color Temperature 9000K	
	140~150	Color Temperature 10000K	
	150~160	Color Temperature 12000K	
	160~170	Custom color temperature one	
170~180	Custom color temperature two		
180~255	Custom color temperature three		
8	0~9	Null	
	10~19	built-in color 1	
	built-in color n	Each 10 data for each built-in color
9	0~10	No function	
	11~255	Strobe speed (255 is the fastest)	
10	0~9	Null	
	10~19	Auto 1	
	Auto 2~7	Each 10 data for one auto
	80~89	Auto 8	
	90~199	Null	
	200~219	Sound 1	
	220~255	Sound 2	

Basic channel mode(5CH)

Channel	Data	Function
1	0~255	Color 1
2	0~255	Color 2
3	0~255	Color 3
4	0~255	Color 4
5	0~255	Color 5

8 OPERATION & SPECIFICATIONS

- The PROFILE 300RGBAL is an LED profile light for on-site decoration purpose.
- Don't turn on the fixture if it's been through severe temperature difference like after transportation because it might damage the light due to the environment changes. So make sure to operate the fixture until it is in normal temperature.
- This light should be keep away from strong shaking during any transportation or movement.
- Don't pull up the light by only the head, or it might cause damages to the mechanical parts.
- Don't expose the fixture in overheat, moisture or environment with too much dust when installing it. And don't lay any power cables on the floor. Or it might cause electronic shock to the people.
- Make sure the installation place is in good safety condition before installing the fixture.
- Make sure to put the safety chain and check whether the screws are screwed properly when installing the fixture.
- Make sure the lens are in good condition. It's recommended to replace the units if there are any damages or severe scratch.
- Make sure the fixture is operated by qualified personnel who knows the fixture before using.
- Keep the original packages if any second shipment is needed.
- Don't try to change the fixtures without any instruction by the manufacturer or the appointed repairing agencies.
- It is not in warranty range if there are any malfunctions from not following the user manual to operate or any illegal operation, like shock short circuit, electronic shock, lamp broke, etc.

9 INSTALLATIONS

For added protection mount the fixtures in areas outside walking paths, seating areas, or in areas were the fixture might be reached by unauthorized personnel.

Before mounting the fixture to any surface, make sure that the installation area can hold a minimum point load of 10 times the device's weight.

Fixture installation must always be secured with a secondary safety attachment, such as an appropriate safety cable.

Never stand directly below the device when mounting, removing, or servicing the fixture.

From a ceiling, or set on a flat level surface (see illustration below). Be sure this fixture is kept at least 0.5m (1.5 ft) away from any flammable materials (decoration etc.).

Please ensure that the led profile spotlight is hung using the appropriate "C" clamp or half cheeseboro. A safety chain or cable should also be used as a secondary point of holding the fixture in case the clamp comes loose. Never hang the fixture without a safety chain or cable. There is an eye-bolt on the back of the fixture to which the safety chain or cable can threaded through and then hung from the secondary point. Make sure the Gel frame (Gel holder) is clipped into position correctly and cannot come loose.

If you are not qualified or have any doubts about hanging the led profile spotlight then do NOT hang it.

Do not clamp the safety cable to the U bracket or clamp. That is not a secondary safety point. A secondary safety point is any point that will adequately hold the led profile spotlight if the "C" clamp or half cheeseboro fails. Then the safety cable would be the backup and stop the fixture from falling to the ground. So do NOT fix the safety cable to the same place that the "C" clamp is attached

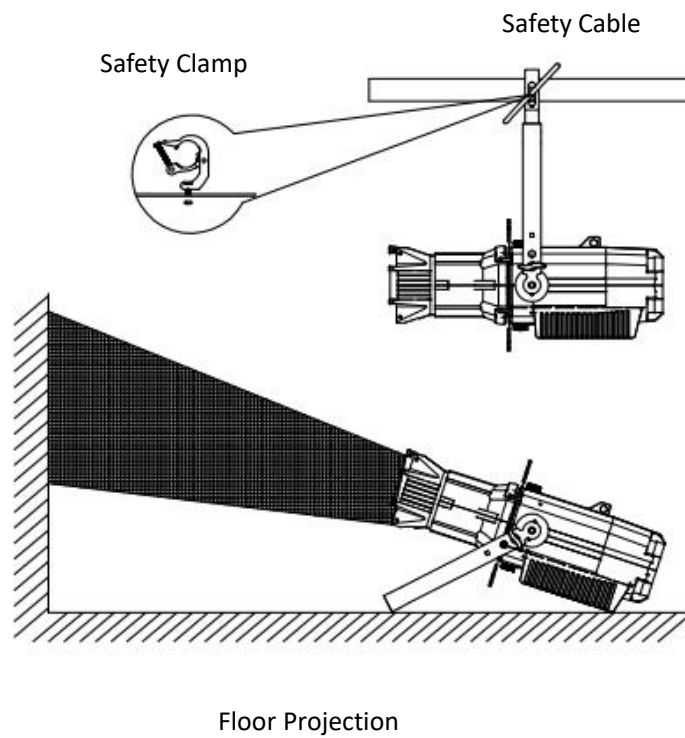



10 Cleaning and maintenance

Now ignoring maintenance and cleaning is very good way of creating problems "down the road" and many companies and installations do just that. However the net result is, no matter what the fixture, premature failure!

Changing the oil in a car, most people do on a regular basis.

So with the fixtures, regular maintenance it an excellent practice, if you want the fixtures to last.

So what is the maintenance for the fixture?

Clean the fans!

Turn off the led profile spotlight.

Using a small vacuum cleaner, suck the dust and "fur balls" out.

Do not use a can of co². That will just blast the dust and dirt everywhere!

The fans keep the LED cool and keep the electronics cool too.

Without the fan working efficiently and dust free, the fixtures will fail and that will be a lot more costly than having someone vacuum the fixtures on a regular basis.

How often should the fans be cleaned? It depends on where the fixtures are; in a very dusty atmosphere once a week. So

check the fans on a regular basis, they may not need cleaned every week but a quick "visual inspection" should be done.

The front lens should be cleaned so the light output is maintained.

The shutter blades sometimes require cleaning as well.

With the led profile spotlight turned off, use only a moist lint-free cloth. Never use alcohol or solvents to clean the fixture.

Never spray anything onto the fixture at the front or in any place on the fixture.